

| ITEM NO. | PART NUMBER | DESCRIPTION  | QTY. | COMPONENT NOTES   |
|----------|-------------|--|------|-------------------|
| 1        | 50-01013    | Connector, dc jack, 5.5x2.5x17.6 mm, molding style, spring contacts, nickel plated, 200 °C | 1    |                   |
| 2        | 24-00419    | Overmold, jack, 18x14 mm, panel mount  | 1    | LCP, 94V-0, black |
| 3        | 55-00308    | O-ring, Ø12.6 ID x Ø16.6 OD x 2.0mm, silicone, black                                       | 1    |                   |
| 4        | 56-00028    | Hardware, washer, lock, 18.1x14.1x1.5 mm, SPCC, nickel plated                              | 1    |                   |
| 5        | 56-00029    | Hardware, nut, hex, 20x3.5 mm, M14x1.25, brass, nickel plated                              | 1    |                   |
| 6        | Epoxy       | Epoxy resin, high temperature  | 2    |                   |

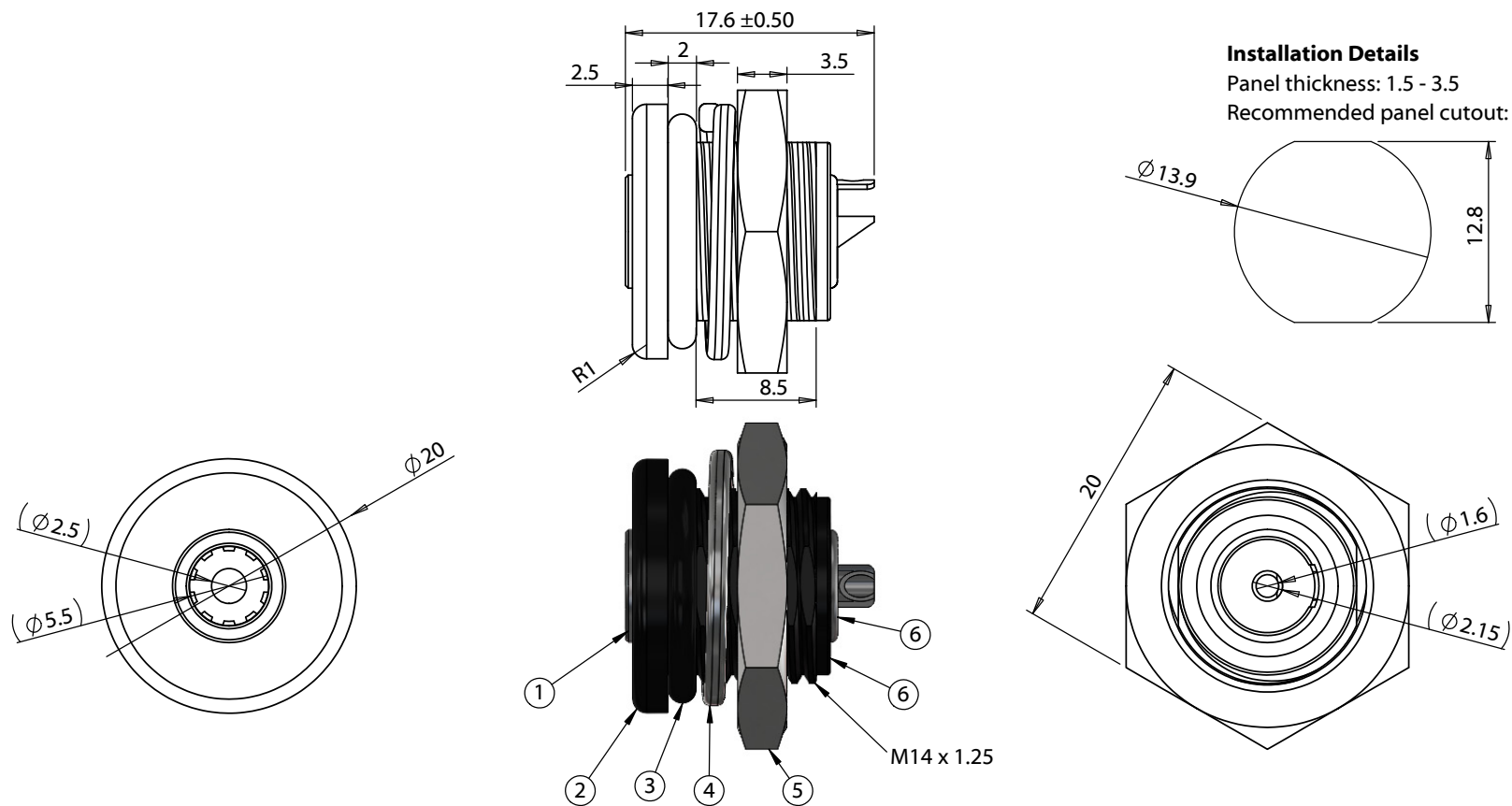

|           |            |                 |  |   |   |                          |
|-----------|------------|-----------------|--|---|---|--------------------------|
| Revision: | Date:      | Description:    | Prepared:  | Notes:  | <h1>TENSILITY</h1> <p>tel 1.541.323.3228 800 877.670.7118<br/> fax 1.541.323.4202 web tensility.com</p> |                          |
| A         | 05/14/2025 | Initial release | Verified:  | RoHS compliant<br>Function test: no open, no short circuit, no intermittent                                       |   |                          |
|           |            |                 | Dimensions are in millimeters.<br>Tolerances:<br>X: ± 0.3 mm<br>X.X: ± 0.1 mm<br>X.XX: ± 0.05 mm | Description:<br>Connector, dc jack, 5.5x2.5xL 17.6 mm, panel mount, nickel plated, IP67, threaded, nut and washer | Size:<br>A  | Part number:<br>54-00407 |
|           |            |                 |  |   | Scale: 2:1  | Sheet 1 of 2             |

**Ratings**  
Maximum Operating Voltage: 48 Vdc  
Maximum Operating Current: 11.5 A

**Operating Temperature Range**  
-50° to 200 °C, relative humidity of 85% or less

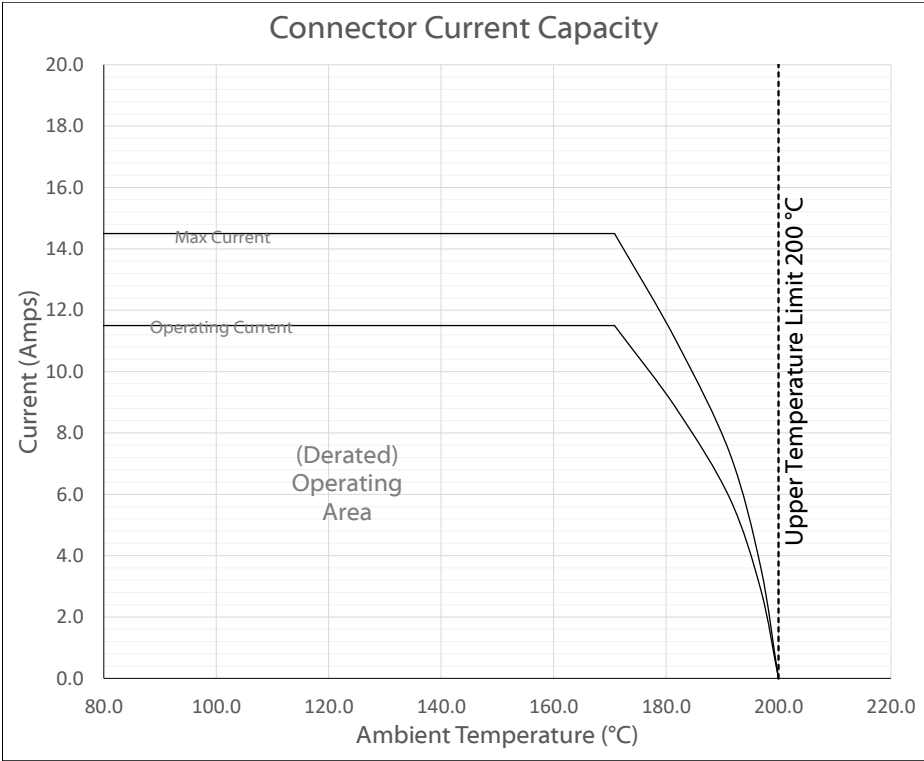

Testing based on IEC 60512-5-2. Max current curve generated with isolated test article under controlled environmental conditions, based on a 40°C temperature rise. Test does not take into account external factors such as housings, mating cables, or other circuitry. Operating current curve (derated by 20% of maximum values) accounts for external factors, and manufacturing variation.

|           |            |                 |  |  |   |              |              |
|-----------|------------|-----------------|--|--|---|--------------|--------------|
| Revision: | Date:      | Description:    | Prepared:  | Notes:   | <div>TENSILITY</div> <div>tel 1.541.323.3228 800 877.670.7118</div> <div>fax 1.541.323.4202 web tensility.com</div> |              |              |
| A         | 05/14/2025 | Initial release | Verified:  | RoHS compliant   |   |              |              |
|           |            |                 | Dimensions are in millimeters.<br>Tolerances:<br>X: ± 0.3 mm<br>X.X: ± 0.1 mm<br>X.XX: ± 0.05 mm | Function test: no open, no short circuit, no intermittent  | Size:   | Part number: |              |
|           |            |                 |  | Description:   | A   | 54-00407     |              |
|           |            |                 |  | Connector, dc jack, 5.5x2.5xL17.6 mm, panel mount, nickel plated, IP67, threaded, nut and washer | Scale: 2:1  |              | Sheet 2 of 2 |