

ITEM NO.	PART NUMBER	DESCRIPTION	QTY.	COMPONENT NOTES
1	50-00543	Connector, dc jack, 5.5x2.5x17.6 mm, molding style, spring contacts, nickel plated, 105° C	1	
2	24-00419	Overmold, jack, 18x14 mm, panel mount	1	Nylon
3	55-00308	O-ring, Ø12.6 ID x Ø16.6 OD x 2.0mm, silicone, black	1	
4	56-00028	Hardware, washer, lock, 18.1x14.1x1.5 mm, SPCC, nickel plated	1	
5	56-00029	Hardware, nut, hex, 20x3.5 mm, M14x1.25, brass, nickel plated	1	
6	Epoxy	Epoxy resin, high temperature	2	

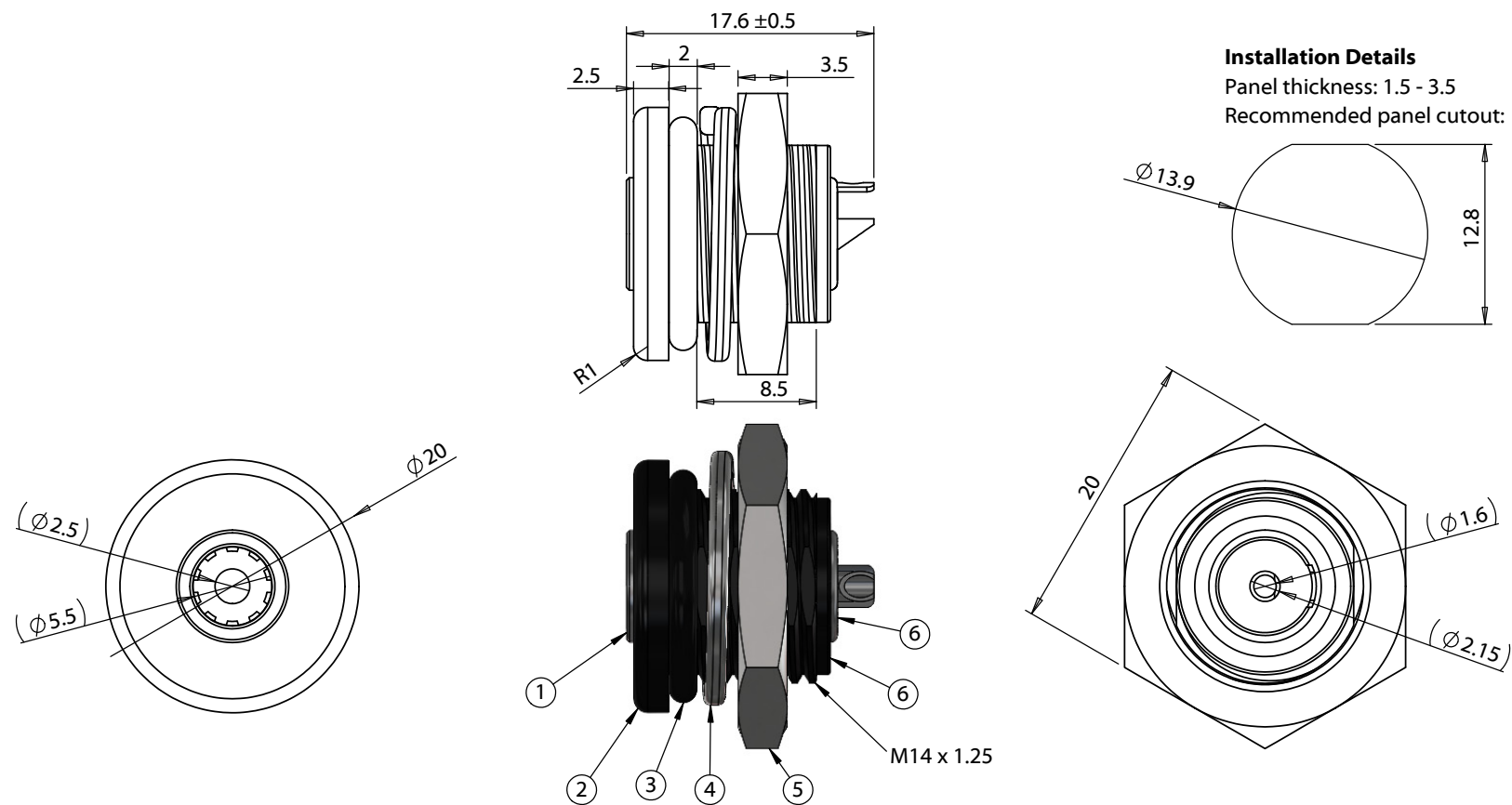

Revision:	Date:	Description:	Prepared:	Notes:	<h1>TENSILITY</h1> <p>tel 1.541.323.3228 800 877.670.7118  fax 1.541.323.4202 web tensility.com</p>	
A	05/08/2025	Initial release	Verified:	RoHS compliant Function test: no open, no short circuit, no intermittent		
			Dimensions are in millimeters. Tolerances: X: ± 0.3 mm X.X: ± 0.1 mm X.XX: ± 0.05 mm	Description: Connector, dc jack, 5.5x2.5xL 17.6 mm, panel mount, nickel plated, IP67, threaded, nut and washer	Size: A	Part number: 54-00527
					Scale: 2:1	Sheet 1 of 2

**Ratings**  
Maximum Operating Voltage: 48 Vdc  
Maximum Operating Current: 6 A

**Operating Temperature Range**  
-25° to 105 °C, relative humidity of 85% or less

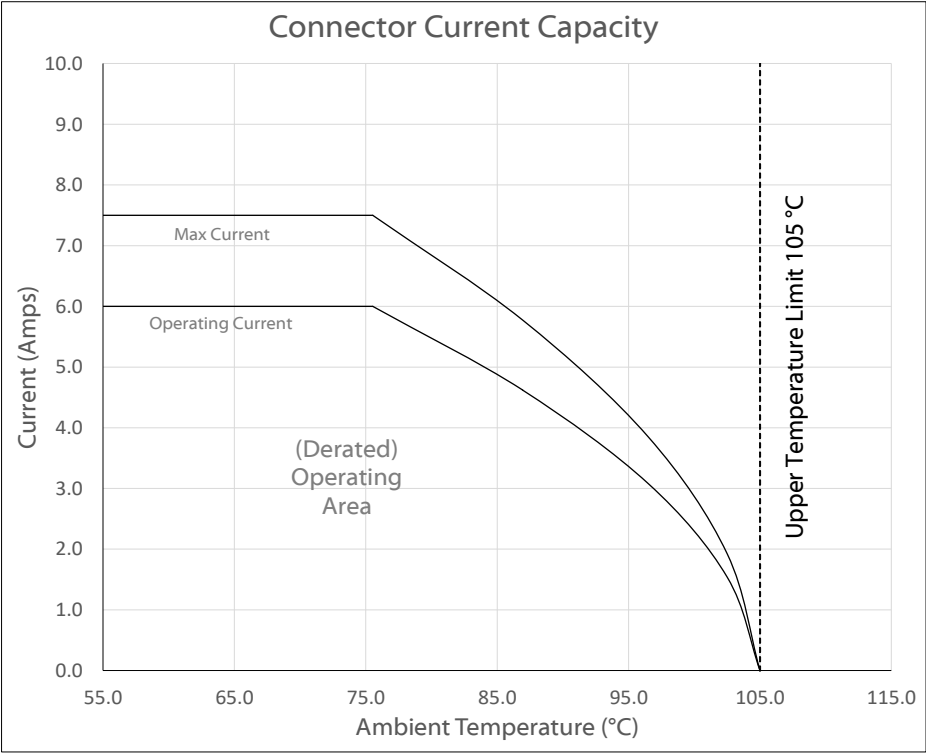

Testing based on IEC 60512-5-2. Max current curve generated with isolated test article under controlled environmental conditions, based on a 40°C temperature rise. Test does not take into account external factors such as housings, mating cables, or other circuitry. Operating current curve (derated by 20% of maximum values) accounts for external factors, and manufacturing variation.

Revision:	Date:	Description:	Prepared:	Notes:	<div>TENSILITY</div> <div>tel 1.541.323.3228 800 877.670.7118</div> <div>fax 1.541.323.4202 web tensility.com</div>		
A	05/08/2025	Initial release	Verified:	RoHS compliant			
			Dimensions are in millimeters. Tolerances: X: ± 0.3 mm X.X: ± 0.1 mm X.XX: ± 0.05 mm	Function test: no open, no short circuit, no intermittent	Size: Part number: A 54-00527		
				Description:			
				Connector, dc jack, 5.5x2.5xL17.6 mm, panel mount, nickel plated, IP67, threaded, nut and washer	Scale: 2:1		Sheet 2 of 2